



 **SIGER**

V1000

Intelligent • Efficient • Reliable • Affordable





V1000

- + Hygienic & efficient system by intelligent linkage program and multi-functional foot control
- + Highly accurate chair memory by delicate sensor technology
- + Super-slim backrest with more relaxing space for dentist
- + Double-joint headrest for treatment of various patients
- + More space and easier maintenance by rotational hydro-group

Unique hygienic design

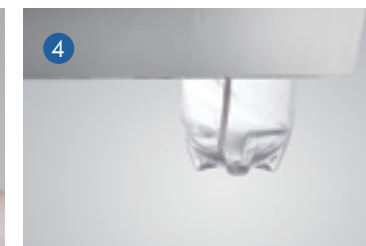

- 1 Autoclavable silicon pad of instrument table
- 2 Detachable ceramic spittoon for cleaning
- 3 Detachable suction system for cleaning
- 4 Distilled water / tap water switching system

Intelligent • Efficient • Reliable • Affordable

Multifunctional foot control

- Automatically access to preset chair position
- Automatically access to preset spittoon position
- Automatic ON/OFF of operating light
- Automatic spittoon rinse
- Automatic cup filling
- Intelligent return to the previous position
- Adjustable chair positions
- Dynamic instruments control

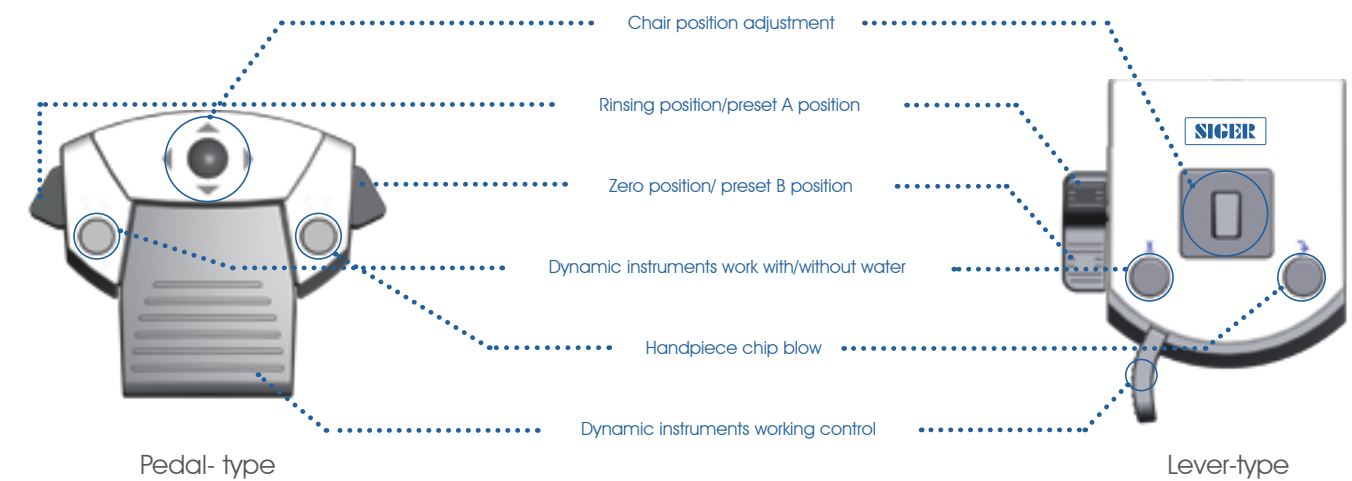



Powerful Dentist Element

- Touch control panel.
- 5 sets of preset intelligent memory positions; only one button to control the chair position, operating light, cup filling and bowl rinsing.
- An inter-locking system for the dynamic instruments preventing the injury and improving working efficiency of dentists.
- Compatible with brush/ brushless micromotor and the speed of it can be adjusted.
- Photoelectric sensors switches controlling the on/off of all the dynamic instruments. (hanging version)

Professional treatment by four-hand operation

- Powerful touch control panel for assistant.
- Photoelectric sensor system controlling the on/off of all instruments.
- Delayed HV suction mechanism.
- Detachable suction tubes and handles for disinfection.

Operating light with sensor

- Unique optical design, ideal depth of focus by full overlay of light sources.
- Even-distributed light spot with clear and smooth edges.
- Similar to natural light with outstanding CRI.

Intelligent • Efficient • Reliable • Affordable

Multifunctional foot control

- Automatically access to preset chair position
- Automatically access to preset spittoon position
- Automatic ON/OFF of operating light
- Automatic spittoon rinse
- Automatic cup filling
- Intelligent return to the previous position
- Adjustable chair positions
- Dynamic instruments control

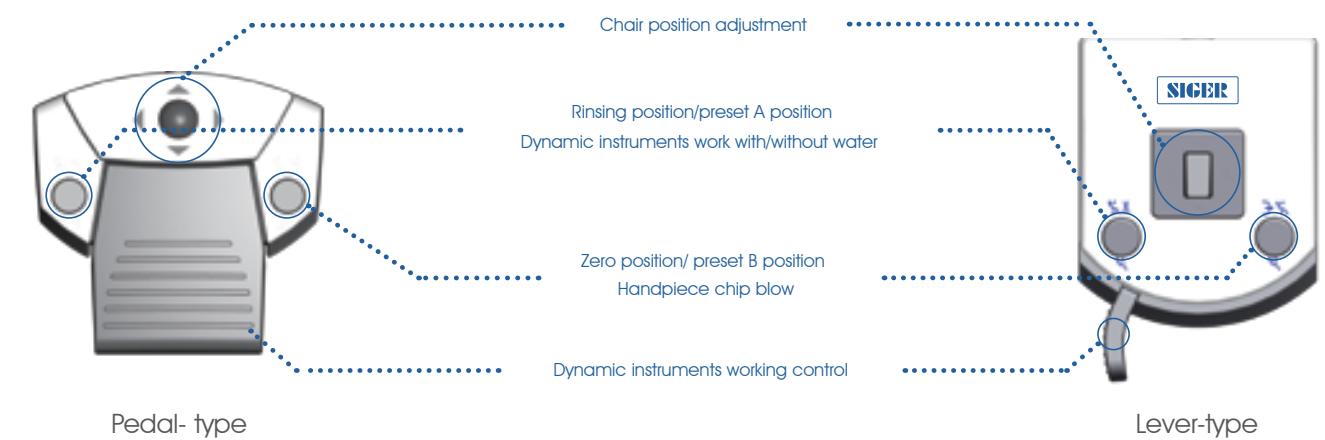

Intelligent • Efficient • Reliable • Affordable

Configuration of V1000

Hydrogroup with 90° rotation

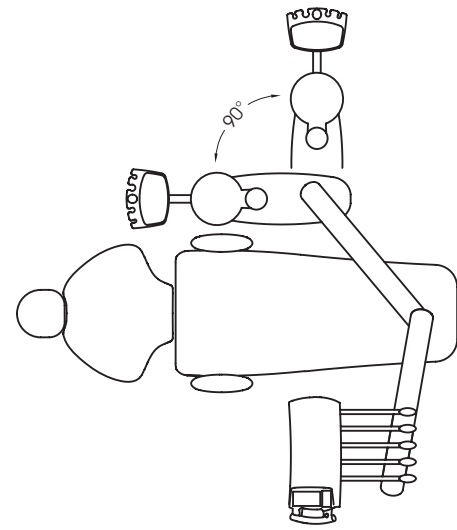

V1000

Comfortable dentist/ assistant stool

- The height of the seat and backrest of dentist stool and the tilt of backrest can be adjusted to meet with ergonomics.
- Assistant stool is optional.



Configuration	V1000
Pneumatic control system	+
Simulating control system	
Swing-type/ hanging-type dentist element	+
Built-in simultaneous control system	+
Touch control panel for dentist	
Button-type panel for dentist	+
Built-in intraoral X-ray film viewer (LED)	+
Two 4-holes tubings for turbine	+
One 4-holes tubing for air motor	+
One 3-way syringe for dentist	+
Touch control panel for assistant	
Button-type panel for assistant	+
One 3-way syringe for assistant	+
One hydraulic saliva ejector	+
One pneumatic HV suction	+
Balance arm with air lock system	+
Multifunctional foot-pedal with program memory	+
LED operating light	
Halogen operating light	+
Rotatable hydro-group	+
Rotatable/detachable hygienic ceramic spittoon	+
Distilled water system	+
Cup filling system with warm water	+
Patient chair with inner-track design	
Patient chair with synchronized function	
Safety protection for chair descending	+
Safety protection for backrest descending	
Denmark chair motor system (Linak)	
Italian upholstery	
Multifunctional headrest	+
Left armrest	+
Dentist stool	+